

**TP9 SF METE**  
OWNER'S MANUAL

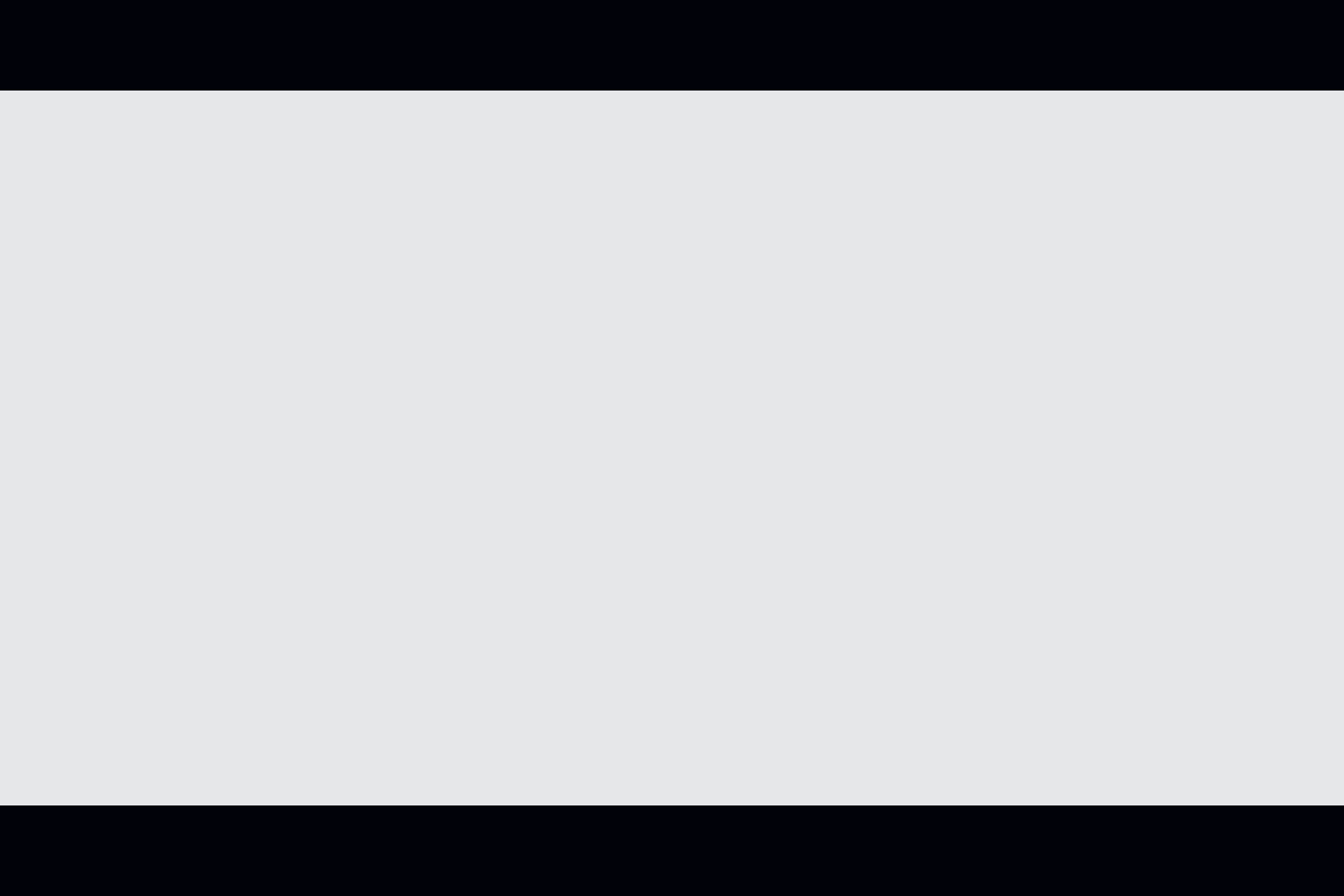

**SUPERIOR HANDGUNS**

**CANIK**  
SUPERIOR HANDGUNS



## FOREWORD

Congratulations on your purchase of CANIK TP9 SF METE, auto loading, single action pistol, chambered in 9x19mm. With proper care and handling, it will give you many years of long and reliable service.

TP9 SF METE is chambered for the 9x19mm.

We specifically disclaim any responsibility for damage or injury whatsoever, occurring as a result of the use of faulty, non-standard or remanufactured ammunition, any modifications or changes made to the firearm; improper use or unsafe handling of the firearm.

Always keep this manual with your firearm. Make sure you understand all the warnings, operation instructions and safety procedures. When you lend, give or sell the firearm, be sure this manual goes with it.

**RESPONSIBILITY FOR THE SAFE USE OF FIREARMS LIES WITH THE SHOOTER. ALWAYS  
TREAT ALL FIREARMS AS IF THEY ARE LOADED AND WILL FIRE AT ALL TIMES!**



### **IMPORTANT!**

**READ ALL INSTRUCTIONS AND WARNINGS IN THIS BOOKLET BEFORE USING THIS FIREARM.**

## CONTENTS

Important Safety Message .....	3
Handgun Safety Rules .....	4
Basics of Safe Gun Handling .....	8
TP9 SF METE Technical Specifications .....	9
Safety .....	11
Loading the Pistol .....	12
Firing the Pistol .....	14
Unloading The Pistol .....	15
Field Stripping .....	16
Disassembly .....	17
Reassembly - Sight Adjustment .....	18
Installing Mag-Well .....	19
Removal of Optic Sight Lid .....	20
Installing the Optic Sights .....	21
Cleaning and Maintenance .....	22
Lubrication Warning .....	23
Limitations of Warranty .....	24
Storage .....	25
TP9 SF METE Exploded View .....	26
TP9 SF METE Parts List .....	27

## **⚠ IMPORTANT SAFETY MESSAGE**

Children are attracted to and can operate firearms which can cause severe injuries or death. Prevent child access by always keeping gun locked, unloaded and separated from ammunition when not in use. If you keep a loaded firearm where a child obtains and improperly uses it you may be criminally liable.

### **Firearm Safety Depends on You**

A gun is only as safe as the person operating it. You can never be overly careful when handling a firearm. Carelessness is often the cause of shooting accidents, such as failing to keep the muzzle pointed in a safe direction, not being sure of your target and what is behind it, leaving ammunition in the chamber or using improper ammunition. Since a bullet can never be called back once fired, such errors in gun handling can result in the loss of life, severe injury or property damage thus, it is crucial for your safety and the safety of those around you that you learn the principles of safe gun handling and storage before you begin to use your new firearm. Be a safe shooter - please read this instruction book thoroughly even if this is not your first firearm purchase as not all firearms are the same. The first step in being a safe shooter is to learn the rules for the safe operation and handling of firearms. **There is nothing more important in gun handling than safety.**

### **Alcohol, Drugs and Guns Don't Mix. Make No Mistake About it!**

Never handle firearms after consuming alcohol or taking drugs that can affect your judgment. Shoot sober! Alcohol, certain kinds of drugs and firearms don't mix. Safe firearms handling requires alertness and concentration on one's actions. You cannot handle a firearm safely after consuming alcohol. Never consume anything that can impair your judgment or physical coordination when handling a firearm. Never allow yourself to be distracted while handling a firearm.

## HANDGUN SAFETY RULES

The Rules of the Firearm Safety must be etched into your memory before you begin to handle firearms. These rules are intended to be understood and followed by all persons handling firearms in the field, on the range or at home. Please read, review and understand these rules before you begin to use or even take your new firearm out of its box. Remember, firearms safety depends on you! Memorizing these safety rules will help prevent gun accidents.

### ▲ Rule #1

Always Keep the Muzzle Pointed in a Safe Direction

This is the most basic and most important safety rule. A safe direction is one in which an accidental discharge will not cause injury to yourself, to others or property damage. This is particularly important when loading or unloading your firearm. Never point your gun at anything you do not intend to shoot. Treat every gun as it is loaded at all times.

### ▲ Rule #2

Firearms Should Be Unloaded When Not Actually in Use

**Firearms should only be loaded when you are in the field or on the target range or shooting area, ready to shoot.** When not in use, firearms and ammunition should be secured in a safe place, separate from each other. Remember to unload your firearm completely so that there is no ammunition in the chamber or magazine. Before handling this or any firearm, or handing it to someone else, visually check the chamber and magazine to ensure they do not contain ammunition. Always keep the gun's action open when not in use. Never assume a gun is unloaded – This or any firearm even if you were the last person to have use it. Never cross a fence, climb a tree, wade through a stream or perform any awkward movement with a loaded gun. Never lean or place a firearm where it could fall. When in doubt, unload your gun! Never pull or push a loaded firearm toward yourself or another person. Never carry a loaded gun in a scabbard, a holster not being worn or a gun case - common sense prevails in gun safety!

### **Rule #3**

Don't Completely Rely on Your Gun's Safety

**Treat every gun as though it could fire at any time, even if you are not applying pressure to the trigger.** The "safety" on a firearm is a mechanical device which, like any such device, can become inoperable at the worst possible time and fail to function. By mistake, you may think the safety is "ON" when it actually is not. Or you may think your gun is unloaded when there is actually a round of ammunition in it. The safety serves as a supplement to proper gun handling but cannot serve as a substitute for common sense. Never handle a gun carelessly and assume that the gun won't fire just because "the safety is on: Never touch the firearm's trigger until you are ready to shoot. Keep your fingers away from the trigger when loading or unloading. Never pull the trigger when the safety is engaged or when the safety is positioned between the "SAFE" and "FIRE" positions. Never place your finger on the trigger unless you intend to fire.

### **Rule #4**

Be Sure of Your Target and What Is Beyond it!

**Once fired, a bullet (or shot charge) can never be called back; so before you shoot, know where the bullet is going and what it will strike.** Be certain your shot will not injure someone or strike something beyond the target. Never fire in the direction of noise, a movement or at any object you cannot positively identify. Make sure your shot has a safe backstop such as a hillside. Keep in mind how far the bullet will travel if it misses your intended target. Never shoot at a hard surface or water as the projectile may glance or ricochet in an unpredictable direction. Once fired, a bullet can never be called back. You are responsible for your actions and judgement.

### **Rule #5**

Use the Correct Ammunition

**Every firearm is designed to use a certain caliber or gauge of ammunition. It is important that you use the correct ammunition for your firearm.** Information on the correct ammunition to use with your firearm appears in the firearm's instruction. Use of wrong manual and the manufacturer's markings on the firearm itself. Use of the wrong ammunition, improperly reloaded ammunition or corroded ammunition can result in the destruction of the firearm, serious personal injury and/or death. Gorw the habit of examining every round of ammunition before you put it into your gun to ensure it is of the proper gauge or caliber and that it is in good condition.

### **Rule #6**

If Your Gun Fails to Fire When the Trigger Is Pulled, Handle With Care

**If a cartridge or shell does not fire when the trigger is pulled, follow Rule #1 and keep the firearm's muzzle pointed in a safe direction.** Keep the muzzle down range with the action closed and wait at least 30 seconds (to ensure that the ammunition is not delayed in firing) before carefully opening the action, unloading the firearm and safely disposing of the ammunition.

### **Rule #7**

 Always Wear Eye and Ear Protection When Shooting

**Exposure to shooting noise can permanently damage hearing. Flying debris, such as powder residue and ejected cartridge cases, can injure your eyes.** Thus, it is only common sense to wear both eye protection (such as shooting glasses) and ear protection (such as a sound-muffling headset) whenever shooting. Also, wear eye protection when cleaning or disassembling your gun to ensure that cleaning solvent and tensioned parts (such as springs) do not come into contact with your eyes.



### **⚠ Rule #8**

Be Sure the Barrel Is Clear of Obstructions Before Shooting

**Discharging a firearm with an obstruction in the barrel can result in personal injury, property damage and/or death.**

Before you load your firearm, check the chamber and magazine to make certain that no ammunition is inside. Also, check the inside of the barrel (called the "bore") to ensure it is free of obstructions. Even a small amount of mud, snow or excess lubricating oil or grease in the bore can cause excessive pressures resulting in a bulged or burst barrel which can injure or kill the shooter and bystanders. It is a good idea to make a habit of cleaning the bore and checking for obstructions with a cleaning rod just before each shooting session. If the noise or recoil experienced upon firing seems low or weak, or something doesn't feel "right," cease firing immediately and carefully check to make sure that there is no obstruction in the barrel smaller cartridge smaller cartridge acting as obstruction.

### **⚠ Rule #9**

Do Not Alter or Modify Your Gun and Have it Serviced Regularly

Firearms are complex mechanisms that are designed to function properly in their original condition. Any alterations or changes made to a firearm after its manufacture can make the gun unsafe and will void its warranty. Do not jeopardize your safety or the safety of others by altering the trigger, mechanical safety or other mechanisms of your firearm. You should have your firearm periodically checked for proper functioning and serviced by a qualified gunsmith.

### **⚠ Rule #10**

Learn the Mechanical and Handling Characteristics of Your Firearm

Not all firearms operate the same way. The method of carrying, handling and operating firearms varies with the mechanical characteristics of each gun. Thus, you should never handle any firearm until you become familiar with the safe handling, loading, unloading and carrying procedures for that particular firearm, as well as the rules for safe gun handling in general.



### **LEAD WARNING!**

Discharging firearms in poorly ventilated areas, cleaning firearms or handling ammunition may result in exposure to lead and other substances known to cause birth defects, reproductive harm and other serious injuries. Have adequate ventilation at all times when shooting. Wash hands thoroughly after exposure.

### **⚠ WARNING! STOP SHOOTING IMMEDIATELY AND UNLOAD YOUR FIREARM**

If your firearm develops a mechanical malfunction; binding or stoppage, spitting powder/gas, a cartridge primer is punctured, a cartridge case is bulged or ruptured, or the sound on firing does not sound quite right. Do NOT try to shot another round, but unload your firearm and lake it and the ammunition to a qualified gunsmith. Do not assume that the firearm is empty merely because you checked the chamber. You must also check the bore and obstruction inside the barrel.

**⚠ WARNING!** Always ensure that the ammunition you are using is clean, undamaged and of the proper caliber before loading your pistol. The manufacturer and distributor of this pistol disclaim any liability for the use of remanufactured, reloaded or hand-loaded ammunition. Protect your investment in this fine firearm by using only factory fresh, quality ammunition. The use of improper caliber or low quality ammunition could result in injury, death and/or property damage upon firing. Remember, firearms safety depends on you!

## TP9 SF METE TECHNICAL SPECIFICATIONS

MODEL	TP9 SF METE
Caliber	9x19mm
Magazine Capacity	15-18 rds
Barrel Length	103.5mm – 4.07"
Overall Length	182mm – 7.16"
Height	133.5mm - 5.25"
Width	37mm - 1.45"
Weight	742 gr – 26.17 oz
Operating System	Single Action
Fire Control	Striker Fired
Safety System	Trigger Safety Lever, Firing Pin Block
Magazine Release	Side Reversible
Striker Status Indicator	Firing Pin(Striker) is visible when cocked
Loaded Chamber Indicator	Visible On Slide
Interchangeable Backstrap	2 sizes available
Sights	3 White Dot Sight Set
Optic Sights	Micro Red-Dot (Shield® Profile)
Slide Release	Ambidextrous

## Diagram showing major operational parts of the TP9 SF METE Semi-Auto Pistol

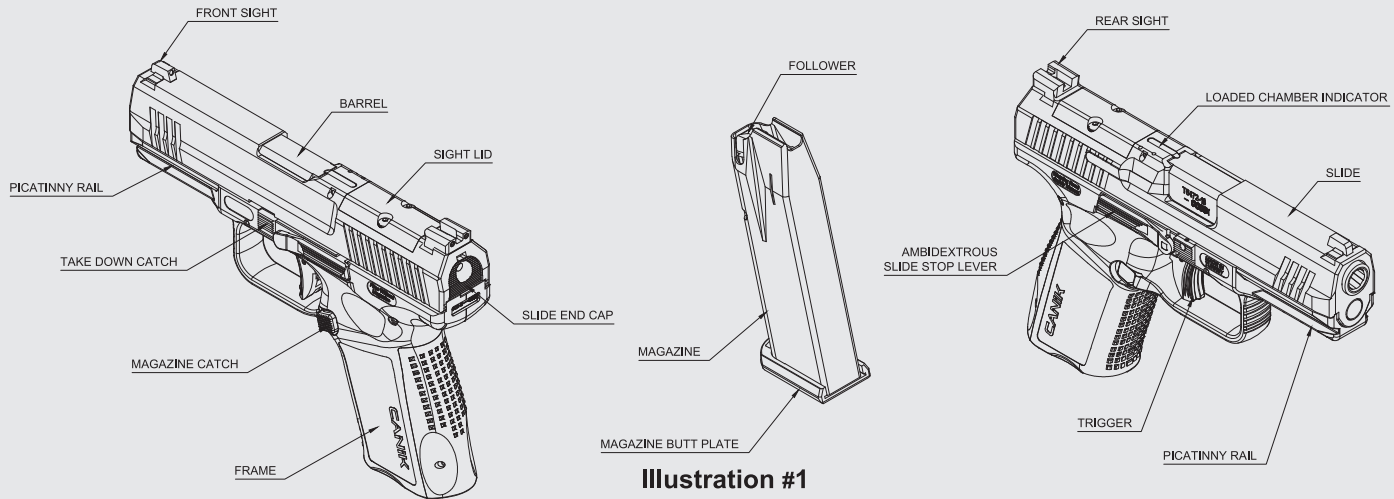

The study of this picture will aid you in understanding the instructions in this booklet.

## Safety

This pistol has an internal firing pin block, which blocks the firing pin from moving forward unless the trigger is pulled and a trigger safety that must be depressed to pull the trigger.

## Loaded Chamber Indicator

This pistol is equipped with a loaded chamber indicator. When the chamber is loaded the indicator is raised from the slide.

(See **Illustration #2**) When the chamber is empty, it is retracts into the slide (See **Illustration #3**)

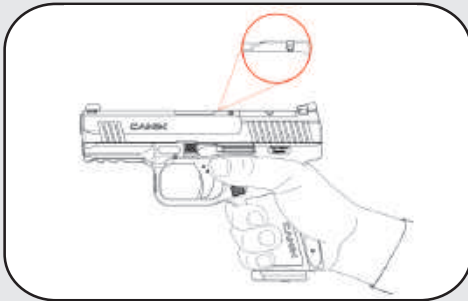

**Illustration # 2**

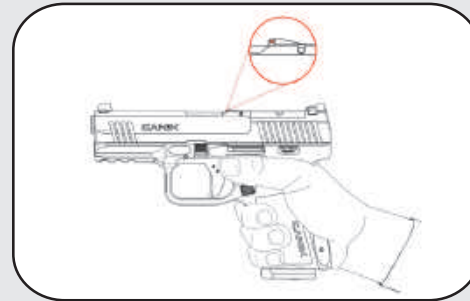
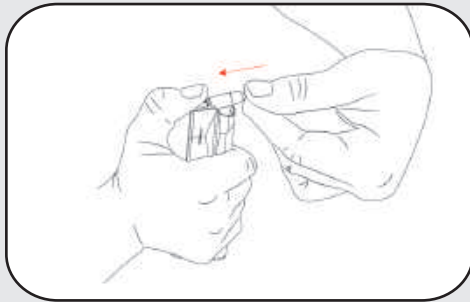

**Illustration # 3**

## Loading the Pistol

**⚠ Pre – Loading Warnings:** Barrel free of obstructions, using correct caliber ammunition, never load indoors, keep fingers off trigger when loading, keep muzzle in safe direction

1. Load the magazine with the correct ammunition by pressing the cartridges one at a time down and under the magazine's feed lips; the cartridges will automatically alternate from side to side. Holding the magazine in your primary hand and gently tapping it against your opposite palm will help seat the cartridges and assure good feeding. When loading the rounds into the magazine, ensure the base of the cartridge is in contact with the back of the magazine.  
**(See Illustration #4)**
2. Keeping your finger outside the triggerguard, pick up the firearm with one hand and the magazine with the other. Insert the magazine into the magazine well and tap up on the magazine with adequate force to insure proper seating.  
**(See Illustration #5)**



**Illustration # 4**

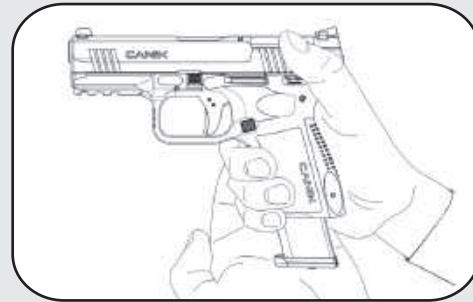
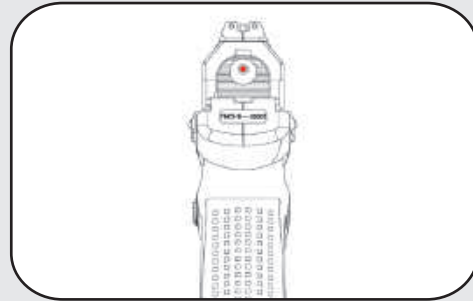

**Illustration # 5**

3. Pull the slide completely rearwards and release it. As it moves rapidly forward under spring pressure, the slide will strip a round from the magazine and load it into the chamber. **(See Illustration #6)** The pistol is now loaded and ready to fire. **The red striker indicator will be visible. (See Illustration #7)**



**Illustration # 6**



**Illustration # 7**

- ⚠ Warning!** The pistol is now loaded and will fire if the trigger is pulled! Handle with extreme caution and keep the muzzle (the end of the barrel) pointed in a safe direction!
- ⚠ Warning!** The red striker indicator is colored in red by paint. By the time the red color can be gone due to wear or dirt.

## Firing the Pistol

1. Keeping the firearm safety rules in mind, aim the pistol downrange at the target. When firing this pistol you may need to experiment with different shooting styles until you find the method which best suits your sporting activity. Always remember to fire the pistol in such a manner that you can maintain a safe muzzle direction at all times.
2. Place your finger inside the triggerguard and on the trigger. Slowly pull the trigger while depressing the trigger safety fully and continue pulling until the striker releases.
3. Being a semi-automatic pistol, the pistol's action (its moving parts) will cycle after the first round is fired. As the slide moves rearwards, the extractor will pull the empty cartridge case from the chamber and eject it from the pistol. (Make sure there are no bystanders in close proximity on either side of the pistol who could be injured by the ejected cartridge case or gasses expelled from the pistol.)  
**NOTE: If the trigger is pressed again, the pistol will fire! Keep the pistol pointed in a safe direction. Keep your fingers away from the muzzle when firing the gun.**
4. Firing may be continued in this manner until the magazine is empty.

**⚠ Warning!** The barrel will be very hot after firing!

**⚠ Warning!** Keep all parts of your body away from the muzzle!

**⚠ Warning!** Always unload your pistol immediately after use and prior to cleaning and storing to minimize the risk of an accidental discharge. If your pistol ever fails to fire, keep it pointed at the target for at least 30 seconds in the event of a hang fire (slow ignition). If the round still does not fire, remove the magazine, eject the cartridge by carefully opening the slide and discard the faulty round. Reload the pistol to resume firing.



## Unloading the Pistol

**⚠ Warning!** Keep muzzle pointed in a safe direction.

1. While keeping the pistol pointed in a safe direction, hold the pistol with one hand, depress the magazine release button with your thumb and the magazine should fall into your free hand. **(See Illustration #8)**
2. Grasp the slide under the rear sight and move it fully rearward, holding the slide fully open inspect the chamber to ensure it is empty.
3. Allow the slide to go forward on the empty chamber. Pull the trigger to lower the striker. Note: When the striker is lowered, the red striker indicator is not visible. **(See Illustration #7)**

**⚠ Warning!** The pistol will fire if the magazine is removed and if the trigger is pulled when a cartridge is in the chamber.  
**Warning!** If dropped, any firearm could fire when there is a cartridge in the chamber.

## Field Stripping

- ⚠ Warning** Before beginning the disassembly process, check to ensure the pistol is not loaded. To do so, follow the procedures detailed in the Unloading the Pistol section on **page 15**
- ⚠ Warning!** Wear eye protection, such as shooting glasses or goggles, when disassembling your firearm to protect your eyes from tensioned parts, such as springs that could be dislodged during disassembly.
1. Before beginning, remove all live ammunition, loaded magazines and other firearms from the working area. Remove the magazine from the pistol. To do so, follow the procedures detailed in the Unloading the Pistol section on **page 15** and confirm the chamber is empty.
  2. While remembering to maintain a safe muzzle direction, secure the unloaded pistol firmly in a supported location such as your lap, or on a table. Pull the trigger to lower the striker. Note: When the striker is lowered, the red striker indicator is not visible. **(See Illustration #7)**
  3. While holding the pistol in your primary hand, grasp the take down catches, located above the trigger. Pull them down using index and thumb fingers of your secondary hand. At the same time using the thumb of your primary hand push the slide forward. **(See Illustration #8 and #9 #10 )** (Please note the slide will only move forward about 1 inch) Lift the slide up while until it is free of frame. **(See Illustration #11)**



Illustration # 8



Illustration # 9



Illustration # 10



Illustration # 11

## Disassembly

1. Holding the slide with primary hand, use your secondary hand to push the recoil spring toward the muzzle and lift it free.
2. Lift the barrel slightly and push it forward toward the muzzle. Then you can pull it back and lift it free from the slide.

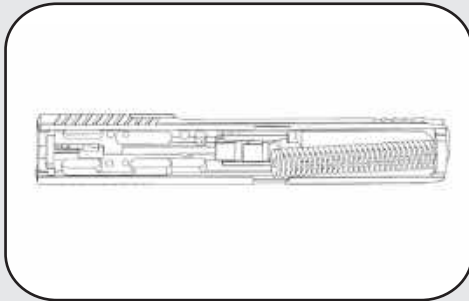

**Illustration # 12**

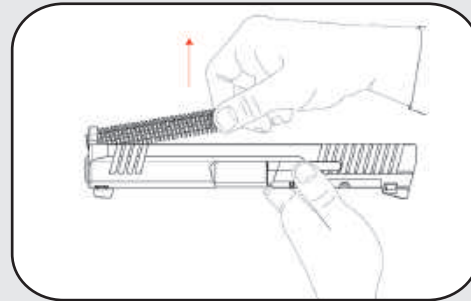

**Illustration # 13**

## Reassembly

1. Hold the slide in your primary hand with the muzzle side facing the ground. Drop the barrel into the slide, turn the slide up so that the muzzle now is facing the sky. The barrel will fall into place.
2. While holding the slide in your primary hand, place the recoil spring in the muzzle end of the slide. **NOTE: The flat end of the recoil spring must be facing the chamber. (See Illustration #14)** Use your thumb on your secondary hand to press the spring towards the muzzle and slightly down.
3. Line the slide grooves up with the frame and slide them back together.

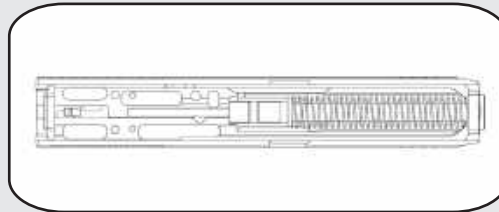

Illustration # 14

## Sight Adjustment

1. The rear sight is drift windage adjustable. If the bullet hits to the right of point of aim (POA), move the rear sight left. If the bullet hits, left of POA, move rear sight right.
2. The front sight is also drift windage adjustable as the rear sight.

## Installing Mag-Well

1. Remove the magazine from the pistol and unload the chamber. To do so, follow the procedures in the Unloading the pistol section on **page 15** and be sure that chamber is empty.
2. Take the Mag-well and locate it in the grip by using front serrations of the grip to hold tight on the entrance of magazine housing as shown in **Illustration #15, #16** Ensure that the hole on the mag-well meets the threaded hole at the bottom of the backstrap.

Then tighten mag-well by using Torx key (T10) and as shown in **Illustration #16**

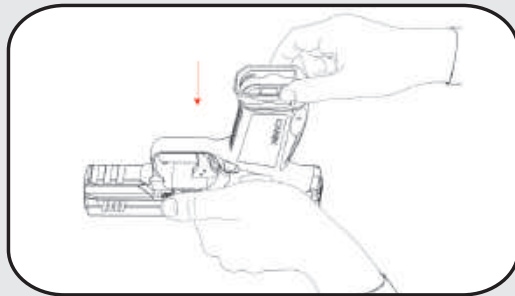

**Illustration # 15**

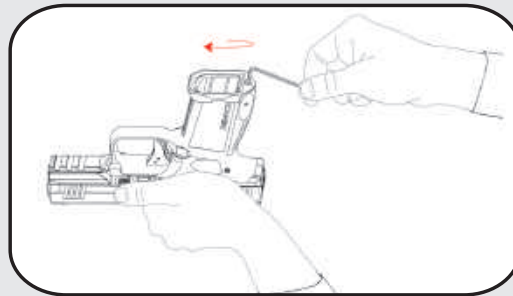
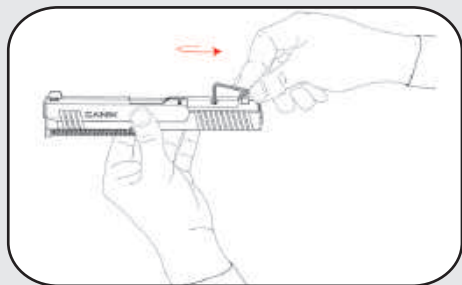

**Illustration # 16**

Note: Mag-Well might be an accessory and may not be available in your package content.

## REMOVAL OF OPTIC SIGHT LID

1. Before beginning, remove all live ammunition, loaded magazines and other firearms from the working area. Remove the magazine from the pistol. To do so, follow the procedures detailed in the, unloading the Pistol section on **page 15** and confirm the chamber is empty.
2. Holding the pistol as shown in **Illustration #17** Use a Torx key (T10) to remove the optic sight lid screws.
3. After removing the rear sight base screws with lock washers, lift the sight base up as shown in **Illustration #18** Please note that as the base fits extremely tight, you may need to follow the directions under Field Stripping on **page 16** to remove the slide. Once the slide has been removed use the Torx key (T10) in the screw hole pictured in **Illustration #19** and push to unseat the optic sight lid. Prying the optic sight lid off may damage the base and/or the slide.



**Illustration # 17**



**Illustration # 18**

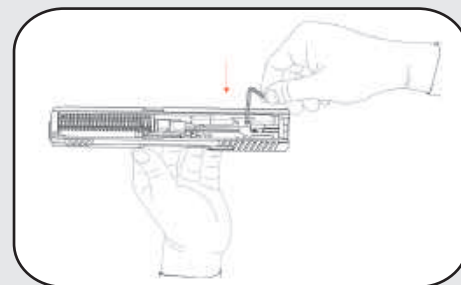

**Illustration # 19**

**Warning!** Before beginning the disassembly process, check to ensure the pistol is not loaded. To do so, follow the procedures detailed in the Unloading the Pistol section on **page 15**.

**Warning!** Wear eye protection, such as shooting glasses or goggles, when disassembling your firearm to protect your eyes from tensioned parts, such as springs that could be dislodged during disassembly.

## Installing Optic Sights

1. Before beginning, remove all live ammunition, loaded magazines and other firearms from the working area. Remove the magazine from the pistol. To do so, follow the procedures detailed in the Unloading the Pistol section on **page 15** and confirm the chamber is empty.
2. Use Torx key (T10) to remove the optic sight lid screws.
3. After removing the optic sight lid, install the interface and make sure that it fits properly into the sockets on your slide as shown in **Illustration #20** and screw the optic sight with by using Torx key (T10) through the interface as shown in **Illustration #21**

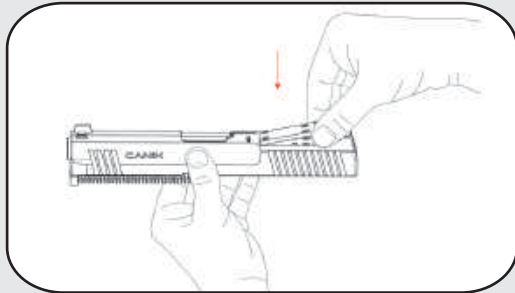

Illustration # 20

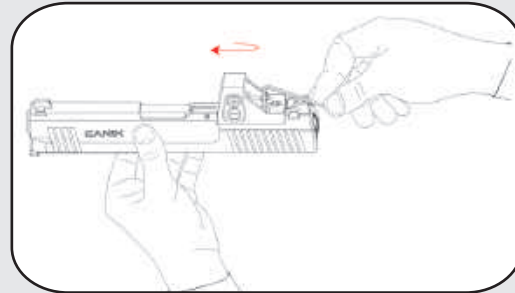

Illustration # 21

## Cleaning and Maintenance

**⚠ Warning!** Before beginning the cleaning process, check to ensure the pistol is unloaded.  
(See the **Unloading the Pistol** section on **page 15**)

**Warning!** You should wear eye protection, such as shooting glasses or goggles, when cleaning your firearm to protect your eyes from tensioned parts, such as springs, that may become dislodged during disassembly.

1. Obtain a quality cleaning kit or use the one if supplied within the pistol case and in addition to the instructions in this section, thoroughly review the cleaning kit manufacturer's instructions.
2. Follow the pistol field stripping procedures. (**See page 16**)
3. To clean barrel, select the correct caliber cleaning brush and attach it to the cleaning rod.
4. Dampen the screw-in nylon bore brush with cleaner, lubricant, protectant (CLP) and then push/pull the brush through the barrel several times from the chamber to the muzzle.
5. Remove the brush and attach a cloth cleaning patch to the cleaning rod and push it through the barrel several times to remove loosened fouling.
6. Repeat this process with the brush and cleaning patches until a final patch comes out clean after swabbing the bore. Apply light coating of CLP to the outer surface of the barrel.
7. Remove shooting residue from the slide and barrel's action parts by the brush and cloth supplied. Apply light coating of CLP to the rails, trigger bar and inside of the ejector assembly of frame and rails on the slide, firing pin block together with the slide's inner side where the barrel operates.
8. Wipe outer surface with a soft cloth dipped in good quality gun oil.



## **Lubrication Warning**

Firing a firearm with oil, grease or any other material even partially obstructing the bore may result in damage to the firearm and injury to the shooter and those nearby. Do not spray or apply lubricants directly on ammunition. If the powder charge of a cartridge is affected by the lubricant, it may not be ignited, but the energy from the primer may be sufficient to push the bullet into the bore where it may become lodged. Firing a subsequent bullet into the obstructed bore will damage the firearm and may cause injury to the shooter and those nearby. Use lubricants properly. You are responsible for the proper care and maintenance of your firearm and ammunition.

## **Warning Concerning Alterations and Aftermarket Parts!**

Altering or modifying parts and/or internal safeties is dangerous and will void the warranty. This firearm was manufactured to perform properly with the original parts and accessories as designed. It is your duty to make sure any parts you buy are made for this firearm and are installed correctly and that neither the replacements nor originals are altered or changed. Your gun is a complex precision tool with many parts that must relate correctly to other parts in order for proper and safe operation. Putting a gun together wrong or with incorrect or modified parts can result in a damaged gun, danger, and injury or death to you and others through malfunction. Always have a qualified gunsmith work on your gun or at least check any work not performed by a gunsmith.

### **Limitations of Warranty**

The Canik warranty will be void if any of the following occur:

1. The instructions in the manual are not followed,
2. Your TP9 SF METE pistol or any of its parts are altered or modified from their original state,
3. Using accessories other than Official Canik Accessory program,
4. Damage is caused by misuse, abuse, or improper maintenance,
5. Your TP9 SF METE pistol is disassembled/assembled beyond the instructions in the manual,
6. Reloaded, remanufactured, or hand-loaded ammunition, or ammunition of a different caliber than your TP9 SF METE pistol is used; or
7. TP9 SF METE used for range rentals or other similar programs are not eligible.

## Storage

Your pistol should be thoroughly cleaned and lightly lubricated before being put away for storage. A light coating of good quality gun oil should be applied to all exposed surfaces. Remove all excess lubrication and use a cleaning rod and cleaning patch to make sure that the bore (the inside of the barrel) is dry and free of obstructions when you remove your pistol from storage and before firing it.

CHECK TO ENSURE THAT YOUR PISTOL IS NOT LOADED BEFORE STORING IT.

ALWAYS STORE FIREARMS AND AMMUNITION SEPARATE FROM EACH OTHER AND OUT OF REACH OF CHILDREN. ALWAYS SECURELY LOCK YOUR FIREARMS AND AMMUNITION IN SEPARATE LOCATIONS WHEN NOT IN USE. REFERENCE YOUR HOME STATE'S FIREARMS REGULATIONS FOR SAFE STORAGE OF FIREARMS AND AMMUNITION.

**NOTE: The use of reloaded, remanufactured, hand-loaded or other non-standard ammunition may result in damage to the pistol and injury or death to the shooter and/or bystanders. The manufacturer does not accept responsibility for malfunctions resulting from use of such ammunition.**

# TP9 SF METE Exploded View

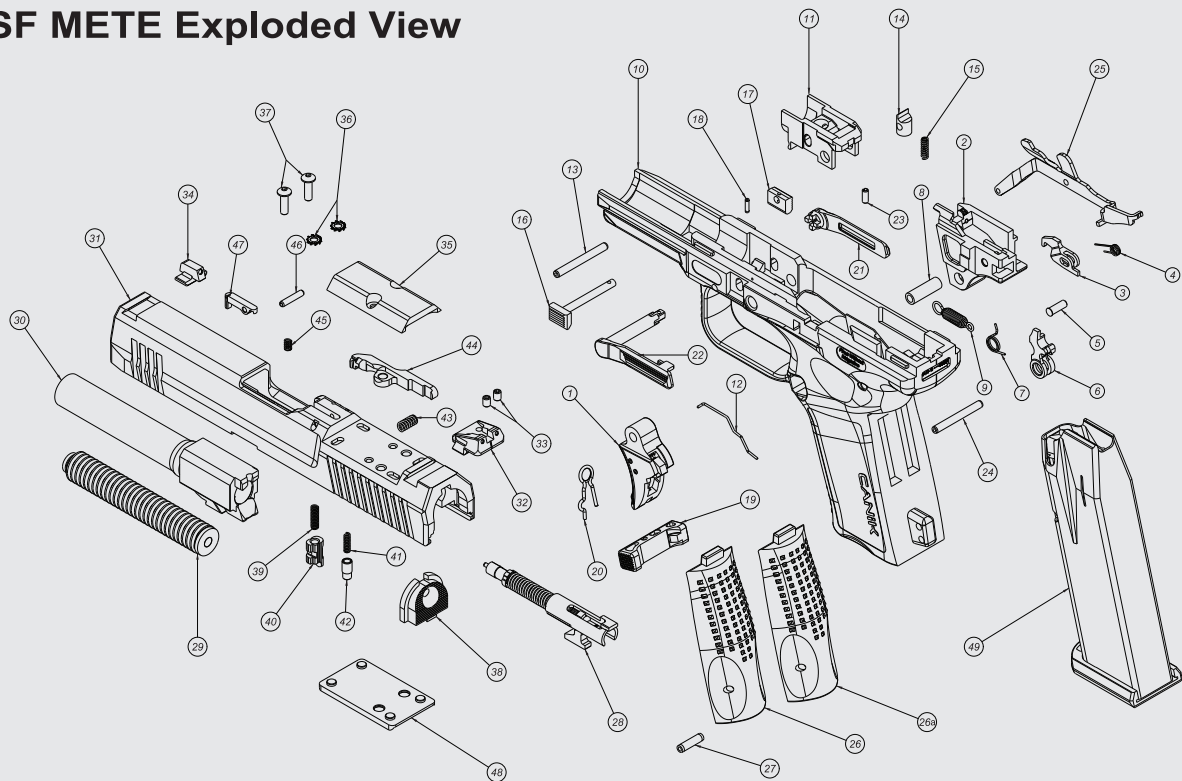

# TP9 SF METE Parts List

<i>Part Name</i>	<i>Canik Code#</i>	<i>Part Name</i>	<i>Canik Code#</i>	<i>Part Name</i>	<i>Canik Code#</i>
1 TRIGGER ASSEMBLY	C55.56-K110	21 RIGHT SLIDE STOP LEVER	C55.56-70	40 FIRING PIN BLOCK	C55.34-34
2 EJECTOR	C55.34-19	22 LEFT SLIDE STOP LEVER	C55.56-17	41 EXTRACTOR PIN SPRING	C55.34-35
3 SEAR	C55.34-22	23 SLIDE STOP LEVER PIN	C55.56-71	42 EXTRACTOR PIN	C55.34-36
4 SEAR SPRING	C55.34-23ops1	24 EJECTOR PIN	C55.34-28V2	43 EXTRACTOR SPRING	C55.34-37
5 SEAR PIN	C55.34-24	25 TRIGGER BAR	C55.42-29	44 EXTRACTOR	C55.34-38
6 SEAR LEVER	C55.48-25	26 BACKTRAP	C55.71-04	45 LOADED CHAMBER INDICATOR SPRING	C55.82-66
7 SEAR LEVER SPRING	C55.34-26	26a BACKTRAP	C55.71-04ops1	46 LOADED CHAMBER INDICATOR PIN	C55.42-67
8 SEAR LEVER PIN	C55.34-28V2	27 BACKTRAP PIN	C55.56-05	47 LOADED CHAMBER INDICATOR	C55.82-68
9 TRIGGER SPRING	C55.42-30	28 FIRING PIN ASSEMBLY	C55.82-K210	48 ADAPTOR	C55.82-79
10 FRAME	C55.66-01	29 RECOIL ASSEMBLY	C55.62-K230	49 MAGAZINE ASSEMBLY	C55.56-K300
11 LOCKING BLOCK	C55.56-08	30 BARREL	C55.62-54	50 SAFETY LEVER PIN	C55.56-72
12 SLIDE STOP LEVER SPRING	C55.56-18	31 SLIDE	C55.62-32ops1	51 SAFETY LEVER	C55.56-73
13 LOCKING LEVER PIN	C55.34-14	32 REAR SIGHT	C55.62-50	52 SAFETY LEVER DETENT	C55.56-74
14 LOCKING LEVER	C55.34-09	33 REAR SIGHT SET SCREW	C55.34-51	53 SAFETY LEVER DETENT SPRING	C55.56-75
15 LOCKING LEVER SPRING	C55.34-10	34 FRONT SIGHT	C55.62-52		
16 TAKE DOWN CATCH	C55.34-11	35 OPTIC SIGHT LID SCREW	C55.82-73		
17 TAKE DOWN PIECE	C55.34-12	36 LOCK WASHERS	C55.53-78		
18 TAKE DOWN CATCH PIN	C55.34-13	37 OPTIC SIGHT LID SCREW	C55.53-74		
19 MAGAZINE CATCH	C55.34-06	38 SLIDE END CAP	C55.62-46		
20 MAGAZINE SRPING	C55.34-07	39 FIRING PIN BLOCK SPRING	C55.34-33ops1		





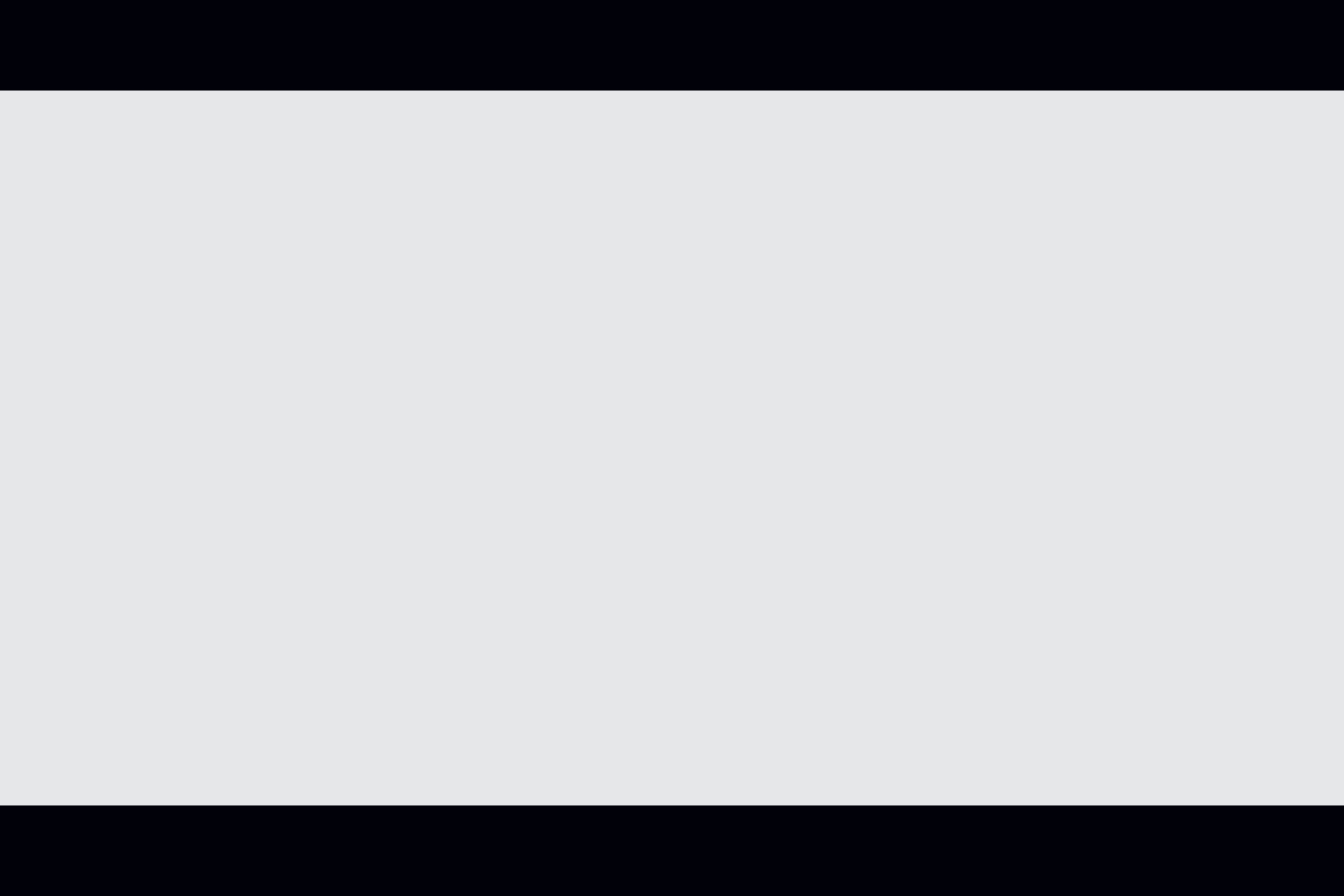



**CANiK**  
SUPERIOR HANDGUNS

[www.canikarms.com](http://www.canikarms.com)

C55.62-KK-EN-19-40